

**INSTRUCTIONS FOR THE USER**  
**Read these instructions carefully before use**

**Bydureon 2 mg powder and solvent for prolonged-release suspension for injection in pre-filled pen**

**How to use Bydureon pre-filled pen**

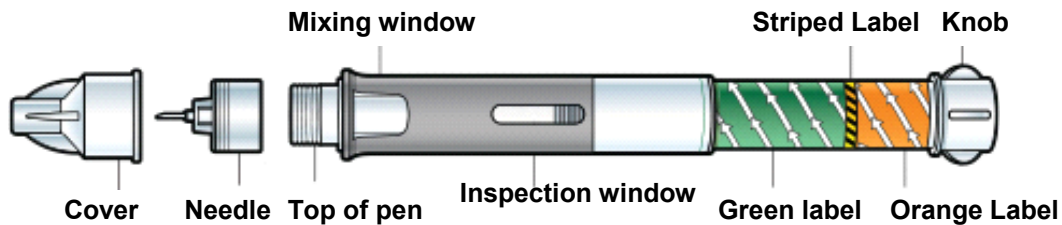

Prior to use of the pen, it is recommended that you should be trained by a doctor or diabetes nurse on its proper use.

Unless a trained person can help to inject this medicine it is not recommended for people who are blind or cannot see well.

**Step 1: Prepare your pen**

**A. Let your pen warm up.**

Remove one pen from the refrigerator and let it stand at room temperature for at least 15 minutes. **DO NOT** use a pen past its expiration date.



**Wash your hands while the pen is warming up.**

**B. Open the tray,**

by pulling on the corner tab. Then remove the pen and needle. **DO NOT** use your pen or needle if any parts are broken or missing.

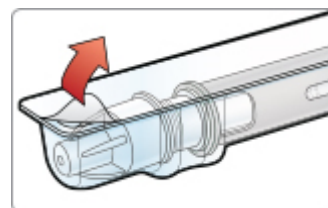

**C. Check the liquid,**

inside the inspection window. It should be clear and free of particles. It's normal if you see air bubbles in the liquid.

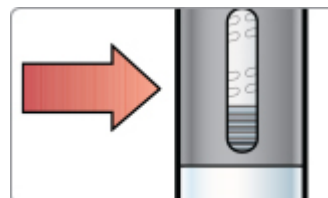

**D. Peel off the paper tab,**

from the needle cover.



**E. Attach the needle to the pen,**

by pushing and screwing it onto the top of the pen until it is tight. **DO NOT** remove the needle cover yet.

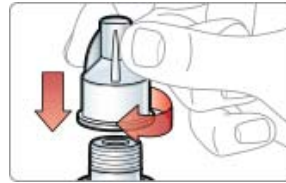

**DO NOT** proceed unless needle is attached

**Step 2: Mix your dose**

**A. Combine the medicine.**

While holding the pen upright with the needle cover uppermost, **slowly** turn the knob anticlockwise. **STOP** when you hear the click and the green label disappears.

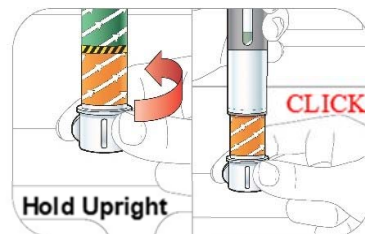

**B. Firmly tap the pen to mix.**

- Hold the pen by the end with the orange label and **tap the pen firmly against the palm of your hand.**
- **WITHOUT** twisting the knob, **ROTATE** the pen every few taps.
- Tap the prefilled pen firmly until a uniformly cloudy suspension with no clumps is obtained.
- You may need to tap 80 times or more.

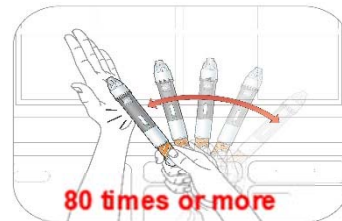

**C. Check the suspension.**

**Hold the pen up to the light and look through both sides of the mixing window.** The solution should have **NO CLUMPS** and be uniformly cloudy.



To get your full dose the medicine must be mixed well.

If it's not mixed well, tap longer and more firmly.



**DO NOT** proceed unless your medicine is mixed well

To get your full dose the medicine must be mixed well. If it's not mixed well, tap longer and more firmly. It's normal if you see air bubbles in the liquid, and they will cause no harm.

**D. Compare both sides of the mixing window to the photos below,**

by holding the pen against the page. Pay attention to the **bottom surface**. If you **don't see clumps** you are ready to inject.

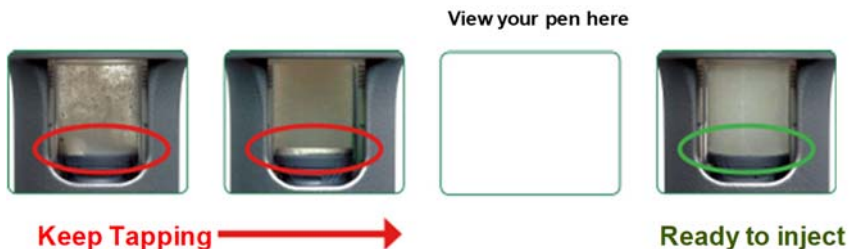

**Step 3: Inject your dose**

**IMPORTANT** Once the medicine is mixed well, you must inject the dose immediately. You cannot save it for later use.

**A. Choose your injection site,**

in either your stomach, thigh, or back of the arm. Each week you can use the same area of your body but choose a different injection site in that area. **Gently clean the area** with soap and water or an alcohol swab.

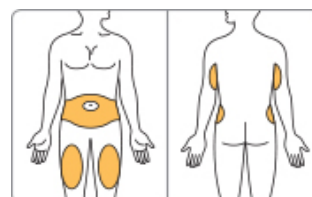

**B. Twist knob to release injection button.**

While holding the **pen upright** with the needle cover uppermost, twist the knob until the orange label disappears and the injection button is released. **DO NOT** push the injection button yet.

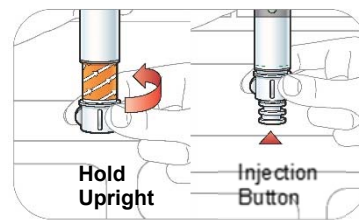

**C. Remove the needle cover,**

by pulling straight off. **DO NOT** twist. You may see a few drops of liquid on the needle or in the cover.



**D. Inject the medicine.**

Insert the needle into your skin (subcutaneously). Press the injection button with your thumb until you hear a click. **Hold for 10 seconds** to make sure you get the full dose.



**E. Properly dispose of your pen,**

with the needle attached, in a puncture-resistant container. **DO NOT** try to recap or reuse the needle.



**Common Questions and Answers**

**1. How do I know that the medicine is mixed well?**

The medicine is mixed well when the liquid looks cloudy from both sides of the window. You should not see any clumps in the liquid. It may help to hold the pen up to the light to see in the window. If you see clumps of any size keep tapping the pen firmly against the palm of your hand until mixed.

**2. I am having trouble mixing my dose. What should I do?**

Remember, before preparing your dose, leave the pen out of the refrigerator for at least 15 minutes. This will let the pen warm up to room temperature. It will be easier to mix the medicine if the pen is at room temperature.

Be sure you are holding the pen at the end with the knob and the orange label. This will help you grip the pen better and tap it more firmly against your palm.

It may also help to tap the mixing window on both sides against your palm. If you see any clumps, keep tapping.

**3. After I mix the medicine, how long can I wait before taking the injection?**

You must inject your dose right after mixing it. If you do not inject your dose right away, small clumps of medicine may form in the pen and you may not get your full dose.

**4. I'm ready to inject my dose. What should I do if I see air bubbles in the pen?**

It is normal for air bubbles to be in the pen. The medicine is injected into your skin (subcutaneously). Air bubbles will not harm you or affect your dose with this type of injection.

**5. What should I do if I cannot push the injection button all the way in when trying to inject my dose?**

Check that you have fully screwed on the pen needle. Also be sure you twisted the knob until it stopped, the orange label disappeared, and the injection button appears.

If you still cannot push the button in, this may mean that the needle is clogged. Remove the needle from your skin and replace it with the spare needle from the carton. Review how to attach the needle. Then choose a different injection site and finish taking the injection.

If you still cannot push the button all the way in, remove the needle from your skin. Use a puncture-resistant container to throw away the pen with the needle still attached.

**6. How do I know if I injected my full dose?**

To be sure you get your full dose, press the injection button with your thumb until you hear a click. After the click, continue to hold the needle in your skin for 10 seconds. This will allow enough time for all the medicine to go from the pen to under your skin.

**7. How do I dispose of my Bydureon pen?**

You will need a puncture-resistant container that is large enough to hold the entire pen with a used needle attached. Be sure the container has a lid. You may use a biohazard container, another hard plastic container, or a metal container. A container is not included in the carton.

Ask your pharmacist how to safely throw away the container with used pens and needles. Do not throw the container in your household waste.

**Instructions for the User was last approved in 11/2018**

CV 18 0121