

Librachrom Hayfever Relief 2% w/v eye drops, solution

sodium cromoglicate

Read all of this leaflet carefully before you start using this medicine because it contains important information for you.

Always use this medicine exactly as described in this leaflet or as your doctor or pharmacist have told you.

- Keep this leaflet. You may need to read it again.
- Ask your pharmacist if you need more information or advice.
- If you get any side effects, talk to your doctor or pharmacist. This includes any possible side effects not listed in this leaflet. See section 4.
- You must talk to a doctor if you do not feel better or if you feel worse after 14 days.

Important information about the administration of this product

Librachrom Hayfever Relief Eye Drops are contained within a novel multidose eye drop bottle, which allows for the solution not to contain any preservatives. Due to the design of the container, administration with these eye drops is not the same as standard eye drop bottles.

- Prior to first use, practice using the drops away from the eye. Slowly squeeze the bottle to deliver one drop in the air to get used to the pressure and time required to deliver one drop.
- Please note that there might be a few seconds delay between squeezing and the drop coming out. Do not squeeze too hard, or more than one drop may come out.
- After use and prior to recapping, the bottle should be shaken once in a downwards direction, without touching the dropper tip, in order to remove any residual liquid on the tip. This is necessary in order to ensure delivery of subsequent drops.

Please read the full instructions on the correct use of this product in **Section 3** of the leaflet ('how to use Librachrom Hayfever Relief'), before using these eye drops.

What is in this leaflet:

1. What Librachrom Hayfever Relief is and what it is used for
2. What you need to know before you use this medicine
3. How to use Librachrom Hayfever Relief
4. Possible side effects
5. How to store this medicine
6. Contents of the pack and other information

1. What Librachrom Hayfever Relief is and what it is used for

Librachrom Hayfever Relief 2% w/v eye drops, solution contains a medicine called sodium cromoglicate which belongs to a group of medicines called anti-allergics.

It works by stopping the release of the natural substances in your eyes that can lead to an allergic reaction. Signs of an allergic reaction include itchy, watery, red or inflamed eyes and puffy eyelids.

These symptoms occur usually in the late spring or early summer when pollen from grasses or trees comes into contact with the eyes of people who are sensitive to them. This condition is sometimes called 'hayfever eyes' or by its medical term: seasonal allergic conjunctivitis.

Librachrom Hayfever Relief is a sterile solution that does not contain a preservative.

2. What you need to know before you use this medicine

Do not use Librachrom Hayfever Relief

- If you or your child are allergic (hypersensitive) to sodium cromoglicate or any of the other ingredients of this medicine (listed in section 6). Signs of an allergic reaction include: a rash, swallowing or breathing problems, swelling of your lips, face, throat, tongue and worsening of redness, itching or swelling of the eye or eyelid.
- If your child is under 6 years of age.
- For other allergic eye symptoms (not caused by hayfever). Other things in everyday life can start allergies causing eye symptoms in certain people. For example, contact with animals including pets, house dust mites, other particles and chemicals. Talk to your pharmacist or doctor.

Do not use this medicine if the above applies to you. If you are not sure, talk to your doctor or pharmacist before using these eye drops.

Warnings and precautions

You must be confident that you or your child's irritated eyes are caused by hayfever, or have been previously diagnosed by your doctor to suffer from hayfever.

You can be sure allergic eyes are caused by hayfever if:

- **Both eyes are affected**
- **You also have a runny or blocked nose**
- **Your eyesight is not affected**
- **You know you suffer from hayfever and your symptoms coincide with the times of year when grass or tree pollen is high.**

But if you or your child have:

- **No nose symptoms**
- **Only one eye is affected**
- **Your sight is affected.**

Or if the eye symptoms:

- **occur at the wrong time of year for hayfever**
- **are likely to be caused by another allergy, e.g. a pet or dust mite allergy.**

Then you cannot be sure that the condition is due to hayfever and you should see your doctor or pharmacist before you use these drops.

If you are not sure if the above applies to you, talk to your doctor or pharmacist before using Librachrom Hayfever Relief.

If you wear contact lenses, follow the instruction for contact lens wearers in section 3.

If you have a history of contact hypersensitivity to silver, you should not use this product.

Children and adolescents

Librachrom Hayfever Relief can be used in children over 6 years of age and adolescents. In children, caregiver supervision and/or assistance may be required.

Other medicines and Librachrom Hayfever Relief

Tell your doctor or pharmacist if you are taking, have recently taken or might take any other medicines.

Pregnancy and breast-feeding

If you are pregnant or breast-feeding, think you may be pregnant or are planning to have a baby, ask your doctor or pharmacist for advice before taking this medicine.

Driving and using machines

You may have blurred eyesight straight after using this medicine. If this happens, do not drive or use any tools or machines until you can see clearly.

3. How to use Librachrom Hayfever Relief

Always use this medicine exactly as described in this leaflet or as your doctor or pharmacist has told you. Check with your doctor or pharmacist if you are not sure.

Adults (including the elderly) and Children over 6 years

The recommended dose is one or two drops in each eye four times a day.

Children under 6 years

This medicine should not be used in children under 6 years of age.

If you have any questions concerning the use of these drops in a child or are unsure if the child has allergic eyes, you should seek advice from your doctor or pharmacist.

If your eyes are no better after 2 days of using the eye drops, see your doctor or pharmacist.

It is best to use your eye drops regularly every day while high pollen levels are expected, to keep your eye condition controlled. **If you find you need to use them continuously for more than 14 days, check with your pharmacist or doctor before continuing.**

How to use this medicine

Before instillation of the eye drops:

- Wash your hands before opening the bottle.
- Do not use this medicine if you notice that the tamper-proof seal on the bottle neck is broken before you first use it.
- At the first use, after cap removal, without positioning the eyedropper above the eye, slowly squeeze the bottle to deliver one drop in the air to get used to the pressure and time required to deliver one drop. In case of difficulties of delivering one drop at a time, this step might be repeated.
- Choose the position that you find most comfortable for the instillation of the drops (you can sit down, lie on your back, or stand in front of a mirror).

Instillation:

1. Hold the bottle directly below the cap and turn the cap to open the bottle. Do not touch anything with the tip of the bottle to avoid contamination of the solution.

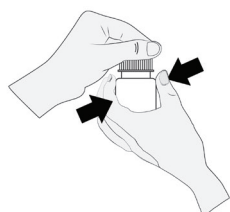

2. Tilt your head backwards and hold the bottle above your eye.

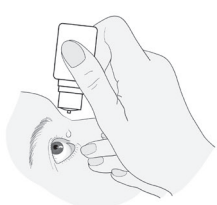

3. Pull the lower eyelid down and look up. Squeeze the bottle gently in the middle and let a drop fall into your eye. Please note that there might be a few seconds delay between squeezing and the drop coming out. Do not squeeze too hard.

If a drop misses your eye, try again.

If you are not sure how to administer your medicine, ask your doctor or pharmacist.



4. Blink a few times so that the drop spreads over the eye.
5. Repeat the instructions 2. – 4. to deliver a drop into the other eye if needed.

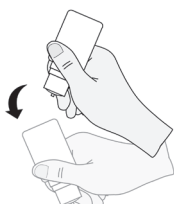

6. After use and prior to recapping, the bottle should be shaken once in a downwards direction, without touching the dropper tip, in order to remove any residual liquid on the tip. This is necessary in order to ensure delivery of subsequent drops.
7. After you have used all doses there will be some Librachrom Hayfever Relief left in the bottle. You should not be concerned since an extra amount of this medicine has been added. Do not attempt to use the excess medicine remaining in the bottle after you have completed the course of treatment.

Do not use the eye drops for longer than 28 days after first opening the bottle.

Contact lens wearers

As with most topical eye medications, if you wear contact lenses, you should remove them before using Librachrom Hayfever Relief. After using this medicine, you should wait 15 minutes before putting your contact lenses back in.

If you use more Librachrom Hayfever Relief than you should

Contact your doctor if you use the eye drops more frequently than the recommended dose.

If you forget to use this medicine

If you forget a dose, use your drops as soon as you remember.

However, if it is nearly time for your next dose, skip the missed dose. Do not use a double dose to make up for a forgotten dose.

If you stop using Librachrom Hayfever Relief

You should keep using these drops if you are still around the things that you are allergic to. If you stop using this medicine your allergy symptoms may come back.

If you have any further questions on the use of this medicine, ask your doctor or pharmacist.

4. Possible side effects

Like all medicines, this medicine can cause side effects, although not everybody gets them.

Stop using this medicine and see a doctor as soon as possible if:

- The itching, redness or swelling gets worse. You may be allergic to these drops.

Talk to your doctor or pharmacist if any of the side effects get serious or last longer than a few days, or if you notice any side effects not listed in this leaflet:

- Stinging or burning in your eyes or blurring of eyesight. This should only last for a short time and occurs immediately after using the eye drops.
- Mild eye irritation.

Reporting of side effects

If you get any side effects, talk to your doctor, pharmacist or nurse. This includes any possible side effects not listed in this leaflet. You can also report side effects directly via the Yellow Card Scheme (Website: www.mhra.gov.uk/yellowcard or search for MHRA Yellow Card in the Google Play or Apple App Store). By reporting side effects you can help provide more information on the safety of this medicine.

5. How to store this medicine

Keep this medicine out of the sight and reach of children.

Do not use this medicine after the expiry date which is stated on the bottle label and carton after EXP. The expiry date refers to the last day of that month.

Store below 25°C. This medicine is sterile when you buy it, so you must not keep it for more than 28 days after opening the bottle.

Do not throw away any medicines via wastewater or household waste. Ask your pharmacist how to throw away medicines you no longer use. These measures will help protect the environment.

6. Contents of the pack and other information

What this medicine contains

- The active substance is sodium cromoglicate. Each 1ml of eye drops contains 20mg of sodium cromoglicate (2% w/v).
- The other ingredients are disodium edetate and water for injections.

What this medicine looks like and contents of the pack

Librachrom Hayfever Relief is a clear colourless to pale yellow aqueous solution in a white opaque plastic bottle containing a white Novelia nozzle that is sealed with a white plastic cap.

The following pack sizes are available: 1 x 5ml, 1 x 10ml

Not all pack sizes may be marketed.

Marketing Authorisation Holder and Manufacturer:

Marketing Authorisation Holder

Aspire Pharma Limited
Unit 4, Rotherbrook Court
Bedford Road
Petersfield
Hampshire
GU32 3QG
United Kingdom

Manufacturer

Rafarm S.A.
Agiou Louka Str.
19002
Paiania
Attiki
Greece

This leaflet was last revised in 01/2021.

1010569-P1.4